

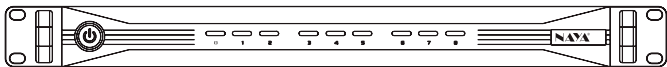

# User Manual of Repeater **AFDI-RP470**



Please keep the manual for reference

## Content

1	Check the items in the package	3
2	Parts introduction	3
2.1	Front panel	3
2.2	Back panel	3
3	Using instruction	4
3.1	Antenna mounting	4
3.2	Indicator	4
3.3	Wireless repeater mode	5
3.4	Grouping mode	5
4	IP networking call	7
4.1	LAN networking call	7
4.2	WAN networking call	8
5	Software configuration	9
5.1	Software installation	9
5.2	Software use	9
6	Maintenance and Cleaning	9
6.1	Maintenance	9
6.2	Cleaning	9
7	Warranty and Maintenance Terms	10
7.1	Scope and duration of warranty	10
7.2	Warranty application	10
8	Warranty card	10

## 1. Check the items in the package

◆ The package contains the following items, if any damage or loss, please contact Naya or the dealer you purchased from.

No.	Item	Q'ty
①	Repeater	1
②	Manual	1
③	Antenna	1
④	Rack fixing screws	4

## 2. Parts introduction

### 2.1 Front panel

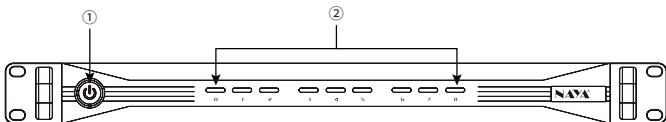

No.	Item	Description
①	Power switch	Power on/off
②	Indicator	Displays the receiving and transmitting status of each channel

### 2.2 Back panel

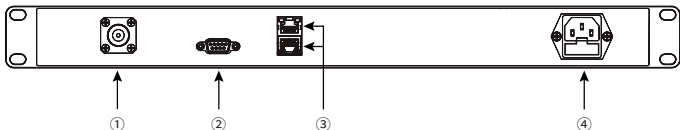

No.	Item	Description
①	Antenna interface	N type female adapter, connected to N type male adapter of sucker antenna
②	Configuration port	RS232 port, data reading and configuration interfaces
③	Network interface	RJ45 interface, function 1: data reading and configuration port
		RJ45 interface, function 2: TCP/IP network port
④	Power connector	AC 110/220V, 50/60HZ

### 3. Using instruction

#### 3.1 Antenna mounting

◆ Antenna installation: First install the antenna to sucker antenna, and then connect the sucker antenna to the device.

◆ Prohibited operation: It is forbidden to directly connect the antenna rod to the antenna interface of the device to, as this will damage the antenna interface of the equipment

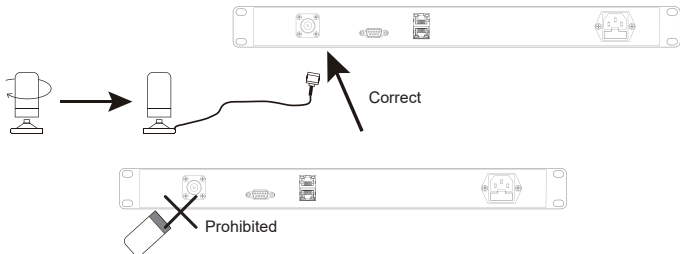

#### 3.2 Indicator

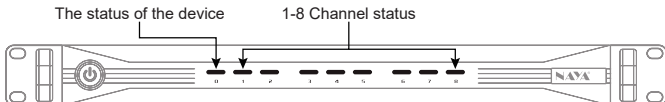

## Focus on R&D Stable and reliable

- ◆ Orange status: channel in transmitting state, channel 00 is orange
- ◆ Blue status: channel in receiving state
- ◆ Channel No.: When mic of beltpacks turned on, channel figure point out beltpack ID. No.  
(Remark: channel No. and beltpack. No. is not absolute one-to-one correspondence)
- ◆ Default mode

When using the repeater alone, 01-08 displays the channel in receiving status.

- ◆ Wireless repeater mode

When wireless repeater function is turned on, the device enters the wireless repeater mode.

Just 4 channels available in wireless repeater mode, 01-04 channel receiving state, 05-08 channel transmitting state.

- ◆ Grouping mode

When the device enter to grouping mode if its connected to wireless base station or control console in grouping mode.

Just 4 channels in grouping mode: 01-04 channel receiving state, channel 05-08 corresponds 01-04 transmitting state.

### 3.3 Wireless repeater mode

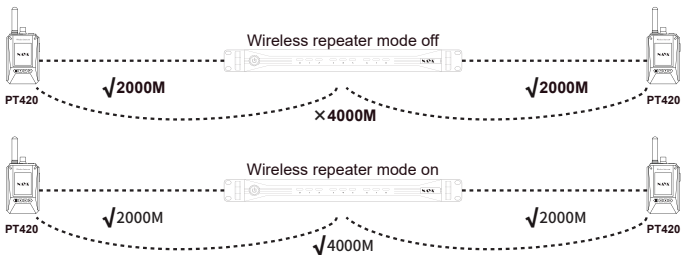

◆ Wireless repeater mode off: within the range of communication, repeater and beltpacks can communicate, but beltpacks out the range can't communicate with each other. 8-way full-duplex.

◆ Wireless repeater mode on: within the range of communication, repeater and beltpacks can communicate, and beltpacks out the range can also communicate with each other with help of wireless repeater function of the device. Full-duplex 8-way full-duplex turned to 4-way.

**NAYA**



**Please read the manual carefully before using the product**

---

Website: <http://www.nayatec.com>

Manufacturer: Shanghai Naya Intelligence Technology. Co.,Ltd.

Address: No.7001 Zhongchun RD., Minhang district, Shanghai, 201101, China

### 3.4 Grouping mode

◆ Grouping mode on: Just used when its connected to wireless base station BS450 in grouping function on.



Remarks:

Call echo: If the device in grouping mode and wireless repeater mode on same time, there would be echo with the intercom.

## 4. IP networking call

### 4.1 LAN networking call

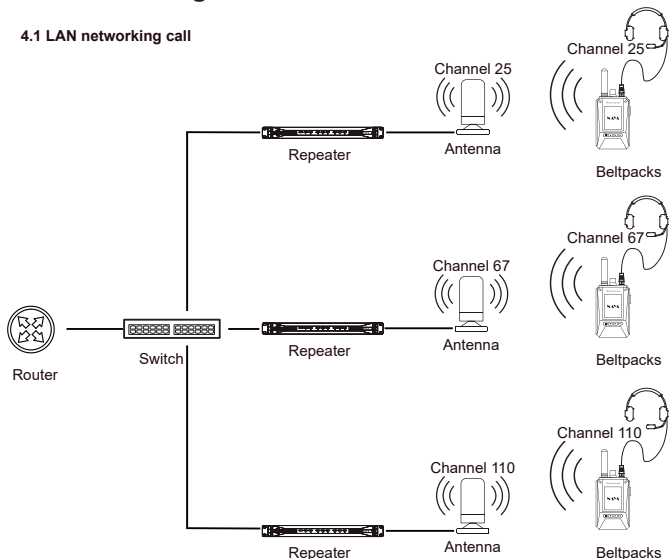

## 4.2 WAN networking call

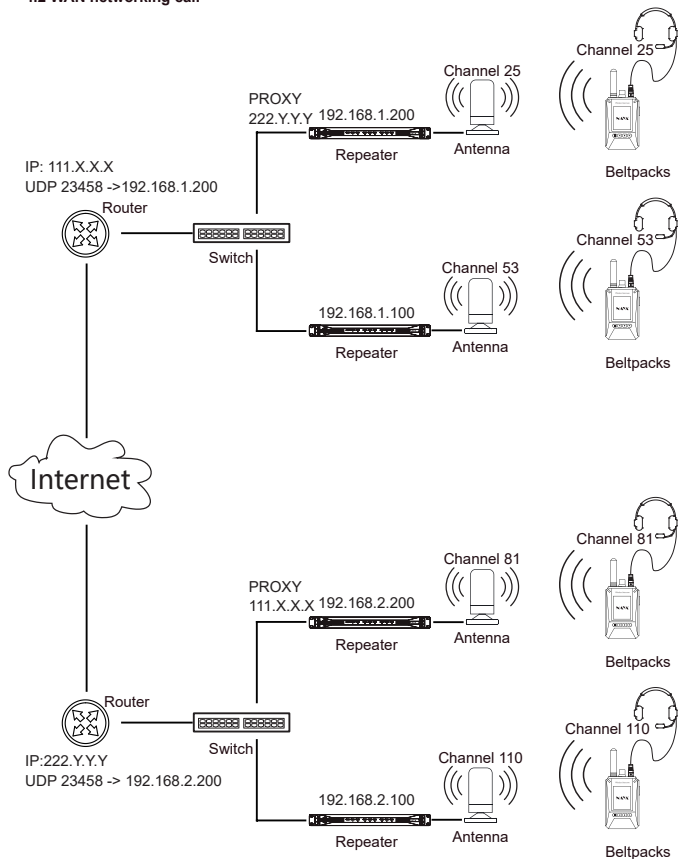



## 5. Software configuration

### 5.1 Software installation

◆ Log in to the [www.nayatec.com](http://www.nayatec.com) website, find the corresponding product model in the technical support, and download the corresponding driver and configuration software according to the tutorial, to install the driver and software.

◆ For any question please contact technical.

### 5.2 Software use

◆ Step 1: Use the networking cable to connect the device to the computer.

◆ Step 2: Open the software, the system will automatically identify the device and read the data.

◆ Step 3: Select the device, set the parameter and to save it.

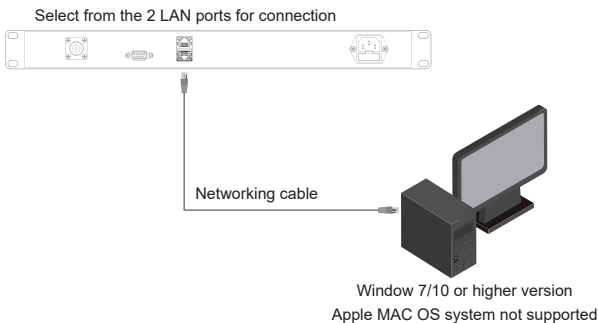

## 6. Maintenance and Cleaning

In order to ensure the good performance of this device and prolong its service life, please be familiar with the following contents for better maintenance and cleaning.

### 6.1 Maintenance

- ◆ Do not puncture or scratch the device with hard objects.
- ◆ Do not store the device in an environment that contains corrosive electronic circuits.

## 6.2 Cleaning

- ◆ Please clean the device regularly, and use a clean and dry towel or brush to remove the dust on the surface of the equipment.
- ◆ If the device casing is dirty, it can be cleaned with neutral detergent and non-woven fabric. Do not use detergent, alcohol or spray which will damage the device, make sure the device is completely dry, otherwise do not use it.

# 7. Warranty and Maintenance Terms

Naya promises that defects in material or workmanship under normal operating and maintenance conditions of all devices produced by our company, are covered by the warranty service specified below from the date of purchase.

## 7.1 Scope and duration of warranty

- ◆ Warranty: 12 months

## 7.2 Warranty application

◆ If you apply for product repair, please be sure to provide the company's product warranty card or a valid purchase invoice as proof of warranty. During the period, the relevant marks of the product shall be kept clean and intact and shall not be torn up.

# 8. Warranty card

In order to protect your rights and interests, please fill in it carefully and keep it properly as a certificate for maintenance.

Reseller information			
Model		Sales date	
Reseller		Contact telephone/E-mail	
User information			
User		Contact telephone	
Address		E-mail	